

# Norovirus

## Patient, Visitor and Carer Information

Infection Prevention and Control Department



The Patient Information Leaflets page on the Trust website is available on the link:  
<https://www.wwl.nhs.uk/patient-information-leaflets> or scan the QR code.

Author ID: IPC Team  
Leaflet Ref: IPC 006  
Version: 2  
Leaflet title: Norovirus  
Last review: September 2023  
Expiry Date: September 2025



## Information for patients, relatives, and carers

This leaflet provides information on Norovirus and how you can help to prevent the spread within the hospital and home environment.

### What is Norovirus?

Norovirus is a virus that is very easily spread, also known as 'winter vomiting bug', which causes gastroenteritis (vomiting, diarrhoea, or both), particularly in places like schools, residential homes, and hospitals, due to the close contact between people.

### Who is at risk of getting Norovirus?

Norovirus can affect anyone, even if you have had Norovirus in the past; patients, staff and visitors can all be affected by the virus.

### How is it spread?

Norovirus is very easily spread from person to person. It can be transmitted by:

- Contact with an infected person.
- Eating contaminated food.
- Contact with contaminated surfaces or objects e.g. door handles, light switches.

### What are the symptoms of norovirus?

The symptoms (as below) begin around 12 to 48 hours after becoming infected and last for between 12 to 72 hours.

- Severe vomiting.
- Watery diarrhoea.
- Or both (vomiting and diarrhoea).

Some people may also have:

- A raised temperature (above 38°C, or 100.4°F).
- Headaches.
- Stomach cramps.
- Aching limbs.

## How can it be treated?

There is no specific treatment for Norovirus, other than allowing the illness to run its course. You will need to drink fluids frequently to prevent dehydration (the symptoms of dehydration include being thirsty, dizziness, dark coloured urine, and dry mouth, eyes, and lips). Apart from the risk of dehydration, Norovirus does not generally cause serious illness and there are usually no long-lasting effects.

If you are pregnant, there is no risk of Norovirus to your unborn child, but it is important to drink fluids frequently to prevent dehydration.

## How do you prevent Norovirus spreading?

The most important way for you and visitors to prevent the spread of Norovirus is to wash your hands with soap and water regularly, in particular:

- Before eating food
- After going to the toilet.

## What precautions are necessary in hospital?

If you are an inpatient in hospital, whilst you have symptoms you may be moved to a single room or nursed in a bay with other patients with the Norovirus (to reduce the risk of spreading it to other patients). All staff caring for you, and any visitors, must wash their hands upon entering and leaving your room/bay. When caring for you, staff will wear gloves and aprons. Visitors will only need to wear gloves and apron if assisting in your personal care.

## Can I still have visitors if I am in hospital?

In Norovirus outbreak situations, it may be necessary to apply visiting restrictions. An information notice will be displayed at the entrance to the ward and your visitors notified.

If your visitors are unwell with diarrhoea or vomiting, they must not visit the hospital until they are symptom-free for 48 hours.

## What can I do if I have Norovirus at home?

If you are unwell at home with diarrhoea and vomiting, you should stay at home and avoid contact with other people where possible. Do not prepare food for others until at least 48 hours after your symptoms have settled, as you may still be infectious (even though you no longer have vomiting or diarrhoea).

- Drink plenty of fluids (non-alcoholic).
- Paracetamol may help relieve the fever, aches, and pains.
- Eat foods that are easy to digest.
- Stay at home and avoid visiting hospitals or care homes until you are 48 hours symptom-free.
- Wash your hands regularly with soap and water, particularly after the toilet and before eating food.

If your symptoms do not get better after a couple of days, or you feel much worse, call 111 or contact your GP for further advice.

### **What precautions do my family and I need to take at home?**

- Wash hands with soap and water, especially before handling food, before eating, after using the toilet, and handling dirty linen or clothing.
- Do not share towels or wash cloths.
- Surfaces in bathrooms, kitchens, and other areas (including door handles, work surfaces and sinks) should be cleaned on a regular basis with a bleach-based household cleaner. Use a detergent-based product on soft furnishings, as they can be damaged with bleach-based products.
- Dirty linen or clothing should be washed separately at the highest temperature recommended on washing care labels.
- Flush away any infected faeces (bowel movements) or vomit in the toilet and disinfect the surrounding area. Flush the toilet with the lid down to stop the virus spreading.

## Hand washing

Hand washing should be undertaken using soap and water using the correct method as shown below:

### 7 Stage Hand Hygiene Technique - Repeat each step 5 times

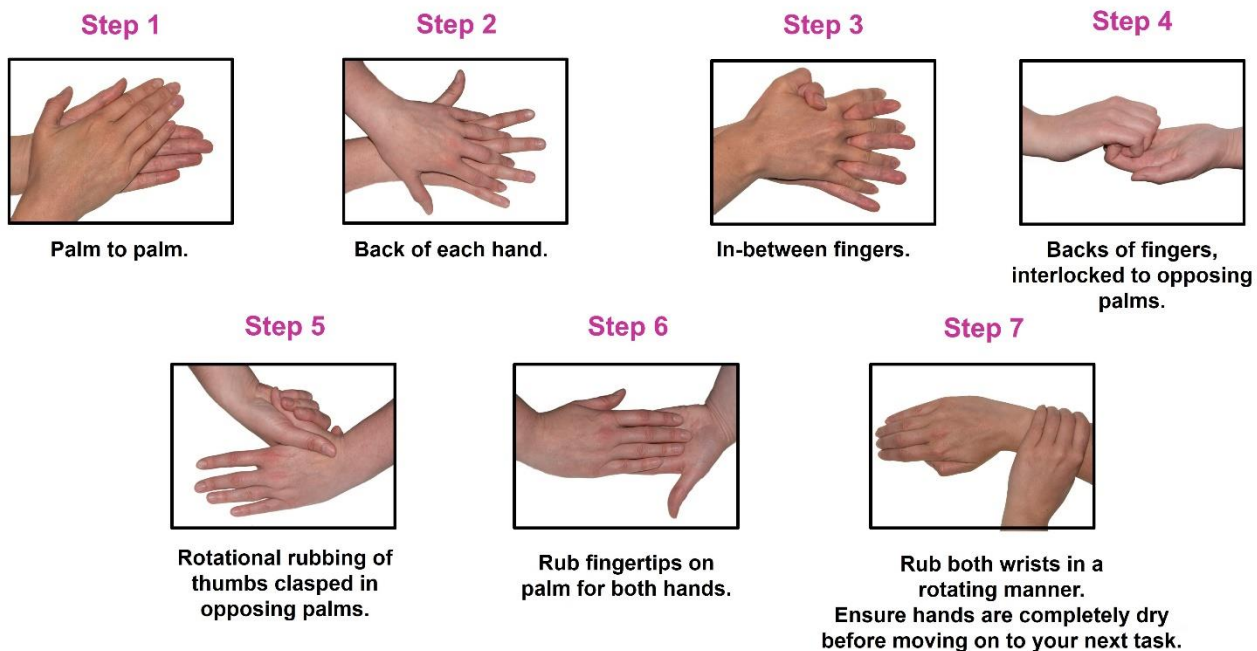

Developed by WWL Medical Illustrations Department.

## Who can I contact for further information?

If you have any questions or would like further information about Norovirus, please do not hesitate to contact a member of staff whilst in hospital, or your GP once you are discharged home.

---

## Comments, Compliments or Complaints

The Patient Relations/Patient Advice and Liaison Service (PALS) Department provides confidential on the spot advice, information and support to patients, relatives, friends, and carers.

## Contact Us

Tel: 01942 822376 (Monday to Friday 9am to 4pm)

The Patient Relations/PALS Manager  
Wrightington, Wigan and Leigh Teaching Hospitals NHS Foundation Trust  
Royal Albert Edward Infirmary  
Wigan Lane  
Wigan WN1 2NN

---

## Ask 3 Questions

Become more involved in decisions about your healthcare. You may be asked to make choices about your treatment. To begin with, try to make sure you get the answers to three key questions:

1. What are my options?
2. What are the pros and cons of each option for me?
3. How do I get support to help me make a decision that is right for me?



---

## How We Use Your Information

For details on how we collect, use, and store the information we hold about you, please see patient information leaflet, Ref. **Corp 006** How we use your information, this can be found on the Patient Information Leaflets page on the Trust website, see details on the front cover.

---

This leaflet is also available in audio, large print, Braille, and other languages upon request. For more information, please ask in the department/ward.

---

© Wrightington, Wigan and Leigh Teaching Hospitals NHS Foundation Trust.  
All rights reserved. Not to be reproduced in whole or in part without the permission of the copyright owner.

**Call 111 first when it's less urgent than 999.**



EMPLOYER RECOGNITION SCHEME

SILVER AWARD

Proudly supporting those who serve.

Phone: 0808 802 1212

Text: 81212

[www.veteransgateway.org.uk](http://www.veteransgateway.org.uk)

